

Mirroring360 Casting Instructions

This tutorial is on the Mirroring360 Chromebook casting software.

Step 1: Find your Mirroring360 ID on your projector computer. It should open up automatically on startup. (Looks like the following)

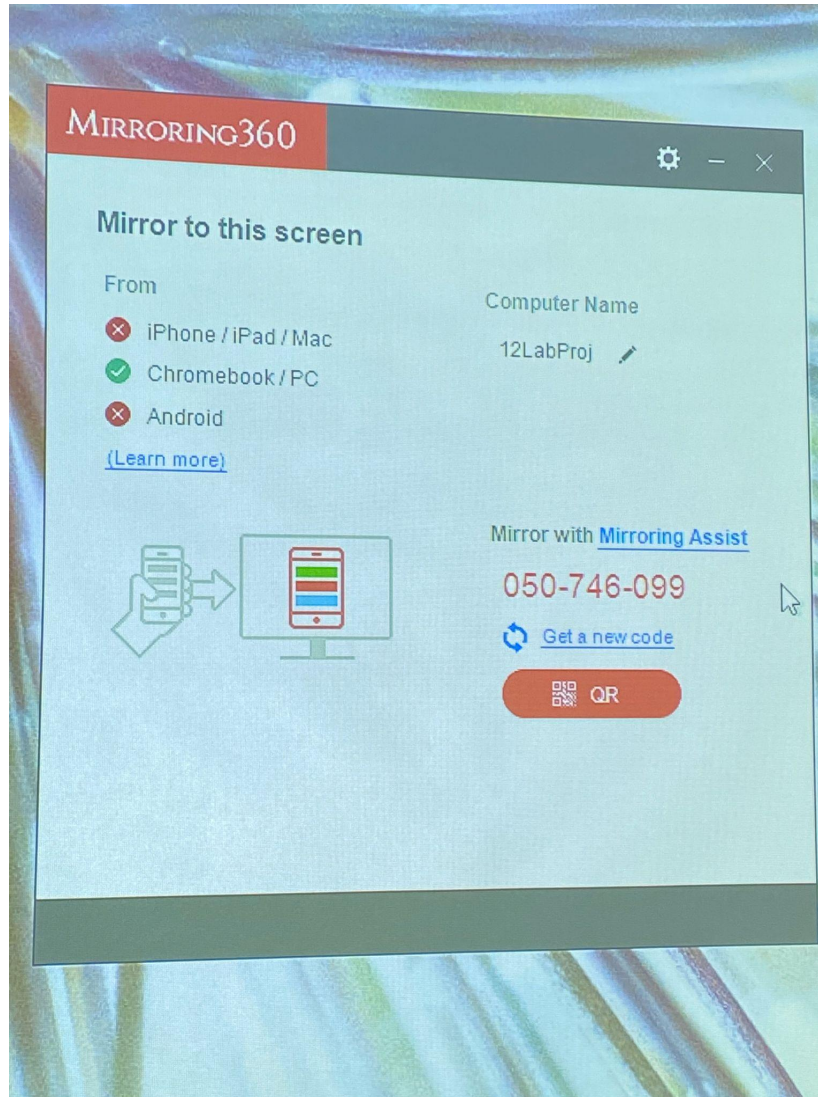

Step 2: Input your ID into your Chromebook extension. (Example Below)

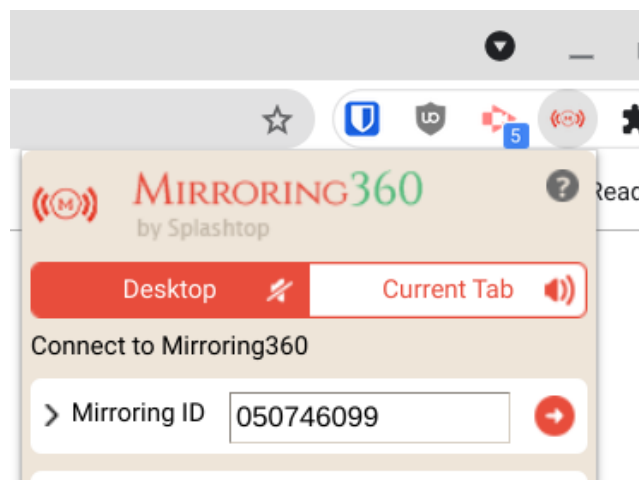

IMPORTANT!

Step 3: Select Desktop or Current Tab. Then hit the arrow next to your ID to cast.

Desktop casting will show your entire Chromebook. For example, all of your tabs, any apps you want to display to your class, etc. **Any audio playing when casting to this will come from your Chromebook.**

Current Tab casting only displays the tab you cast from. **This is the one you want to use when you cast a video. This will allow the audio to come from your classroom speakers.**

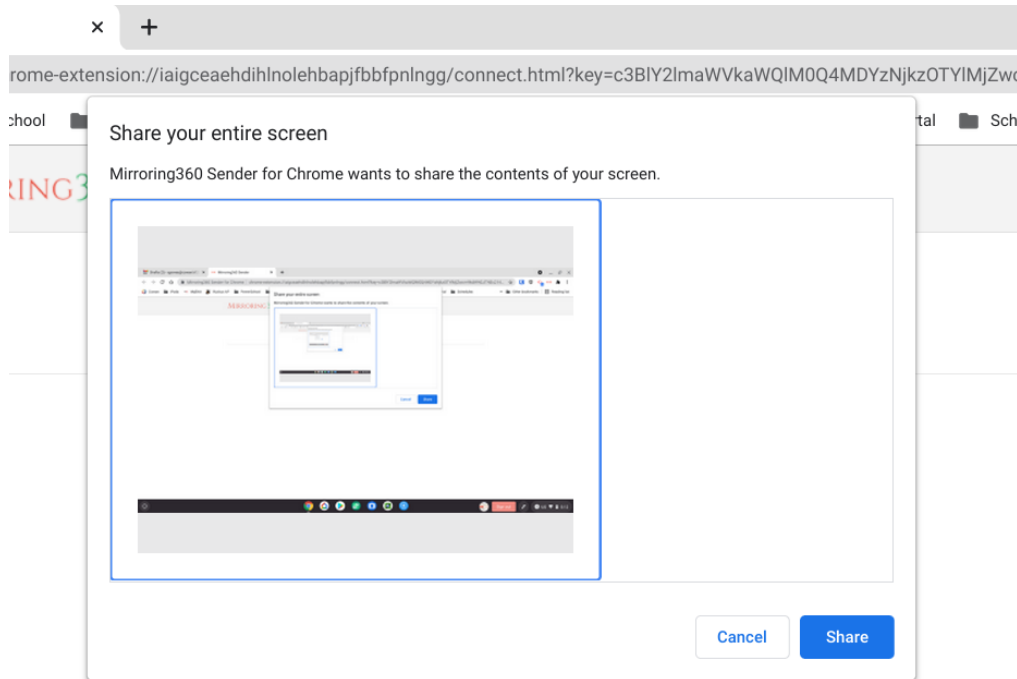

(Desktop mode example ↑) Select screen then hit your share button.

Step 4: Favorite your classroom. When you start casting a new tab opens on your Chromebook. (Example below)

To favorite your classroom, hit the heart next to your computer name. This will add it to your favorites in your casting extension.

Please keep this page opened while using Mirroring360 to share computer screens.

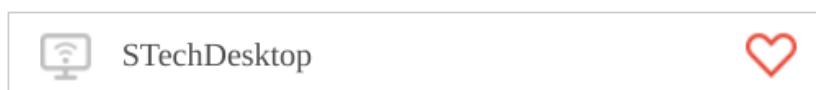

STOP SHARING

Step 5: Finally how to stop casting. You can stop casting by shutting the tab that opens when you begin casting or hitting the “Stop Sharing” button in the same tab.

MIRRORING360 by Splashtop

Please keep this page opened while using Mirroring360 to share computer screens.



STechDesktop



STOP SHARING